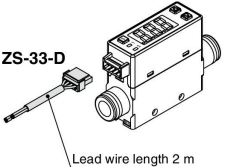
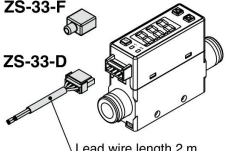
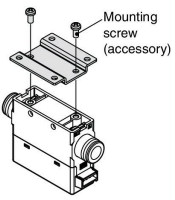
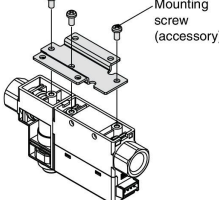
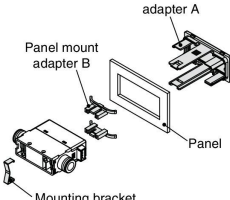
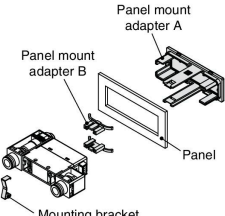

## Option 1

NII	W	Z
With lead wire with connector (2 m)	With lead wire with connector (2 m) + Rubber cover for connector (silicon rubber)	Without lead wire with connector
 <p><b>ZS-33-D</b></p> <p>Lead wire length 2 m</p>	 <p><b>ZS-33-F</b></p> <p><b>ZS-33-D</b></p> <p>Lead wire length 2 m</p>	

## Option 2

NII	R	S	T
None	Bracket (For without flow adjustment valve) <b>ZS-33-M</b>	Bracket (For with flow adjustment valve) <b>ZS-33-MS</b>	Panel mount adapter (For without flow adjustment valve) <b>ZS-33-J</b>
	 <p>Mounting screw (accessory)</p>	 <p>Mounting screw (accessory)</p> <p>Piping direction: Cannot be mounted with bottom piping type.</p>	 <p>Panel mount adapter A</p> <p>Panel mount adapter B</p> <p>Panel</p> <p>Mounting bracket</p>
V			
Panel mount adapter (For with flow adjustment valve) <b>ZS-33-JS</b>			
 <p>Panel mount adapter A</p> <p>Panel mount adapter B</p> <p>Panel</p> <p>Mounting bracket</p>			

Each option is not assembled with the product, but shipped together.

## Made to Order

Symbol	Specification/Description
<b>X693</b>	Change of piping entry direction
<b>X694</b>	combination
<b>X731</b>	Compatible with argon (Ar) and carbon dioxide (CO <sub>2</sub> ) mixed gas

For details, refer to page 249 through to 251.

## DIN Rail Mounting Bracket (Order Separately)

### ZS-33-R

Stations	
1	1 station
2	2 stations
3	3 stations
4	4 stations
5	5 stations

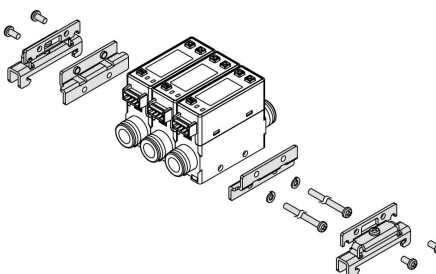

- DIN rail (supplied by customers)
- Port size F02: G 1/4 cannot be mounted on the DIN rail.